

EDGES DEVELOPMENT

The vision at the Edges -

*The newest planned office community
and a gateway to Sioux Falls!*

- There are currently four parcels available for sale or lease. Properties vary and sizes and price, build-to-suit or build your own.
- Parcels available are:
 - Site A** - 163,128 sq ft - \$6.25 psf
 - Site B** - 169,019 sq ft - \$6.25 psf
 - Site C** - 534,860 sq ft - \$6.25 psf
 - Retail Site** - 140,850 sq ft - \$8.00 psf
- Co-Development Businesses include: Meta-Bank Systems, Truks & Trykes Daycare, Ulteig Engineers, Knology & Sanford, Midland National Life, and Total Card,

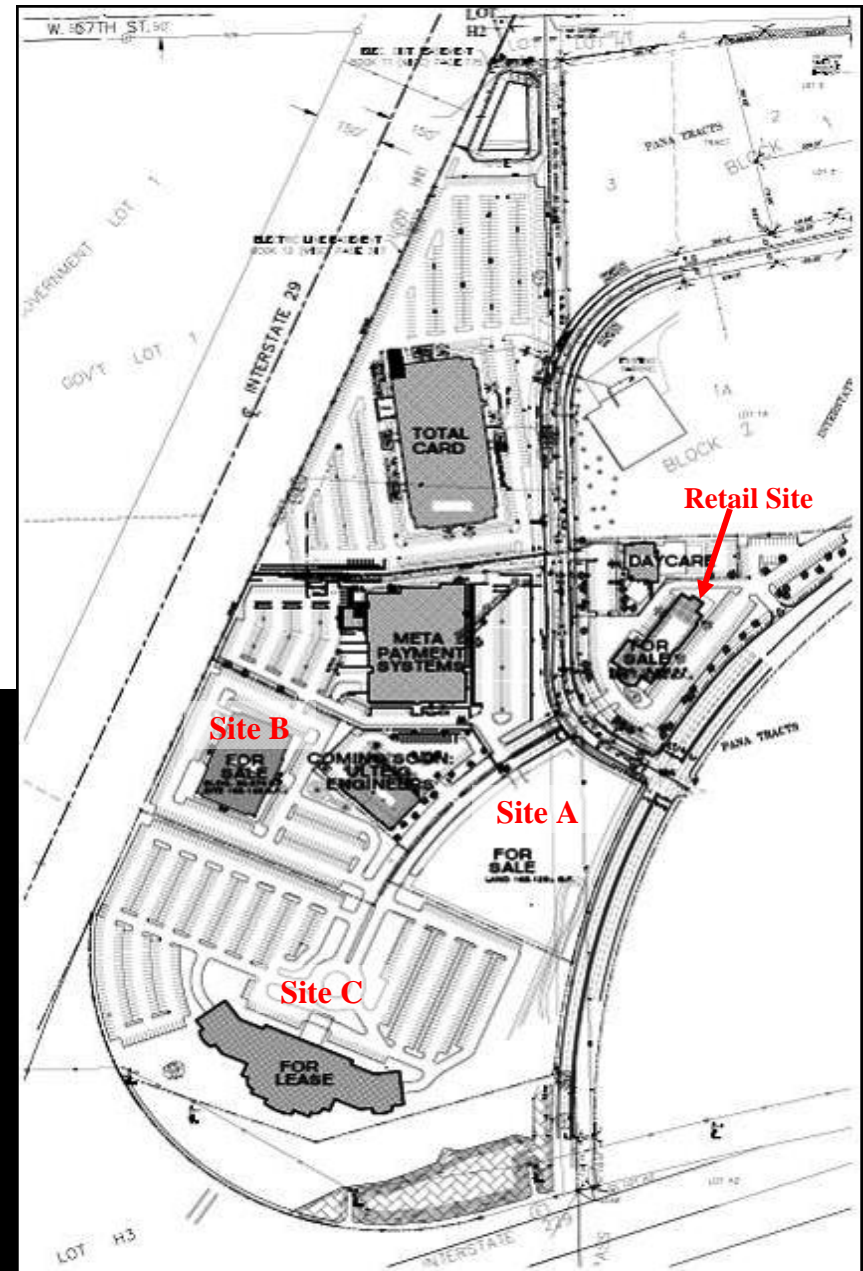

For More Information Contact:

Raquel Blount
 (605) 728-9092 - Cell
 (605) 275-4251 - Direct
 raquel@lloydcompanies.com
 www.lloydcompanies.com

